

Sani Grinder - How to apply/change Sanding Belts

PRIOR TO APPLYING/CHANGING A SANDING BELT, ENSURE TO SWITCH THE MAINS POWER OFF.

1. Turn the Chuck Throw Off clockwise (away from you) until the drum is loose or pushed from the tapered shaft.

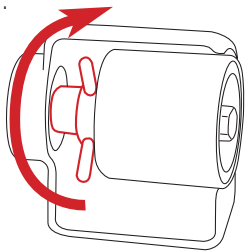

2. Remove the Drum from the unit.

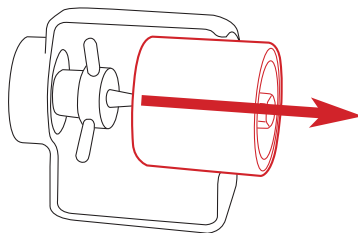

3. **IMPORTANT:** Turn the Chuck Throw Off anti-clockwise (towards you) so it is back at its original position.

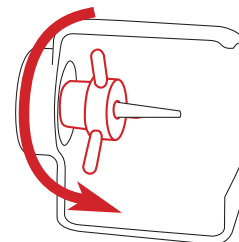

4. Un-screw and remove the nut and bolt from the drum.

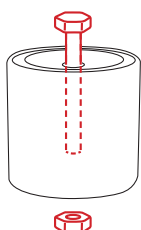

5. Remove the metal caps at each end of the drum.

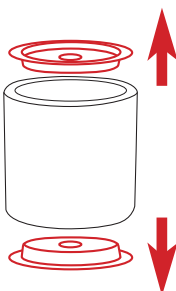

6. Push the inner drum out of the outer rubber drum.

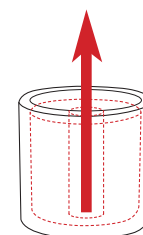

7. Remove the old sanding belt from the rubber drum.



8. Slide the new sanding belt over the rubber drum.



9. Insert the inner drum and push the metal caps into each end of the rubber drum.

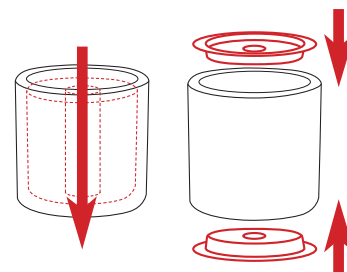

10. Re-assemble nut and bolt into sanding drum.

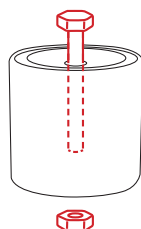

11. Push the drum back onto the unit. Give a good tap to the bolt to ensure a secure fit. The tapered shaft will hold the drum in place.

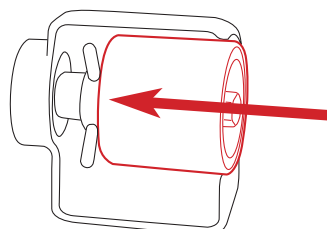

Your SaniGrinder is now ready to use.

If you have any problems applying/removing sanding belts please contact our Service Team on 1800 33 4142.

briggatemedicalcompany

Sani Grinder - How to apply/remove Polishing Buff

PRIOR TO APPLYING/REMOVING DRUM, ENSURE TO SWITCH THE MAINS POWER OFF.

PLEASE NOTE: The Tapered Chuck and Polishing Buff are not supplied with the purchase of a SaniGrinder.

1. Turn the Chuck Throw Off clockwise (away from you) until the drum is loose or pushed from the tapered shaft.

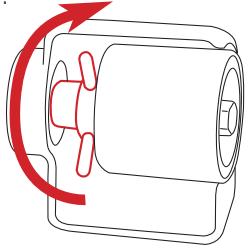

2. Remove the Drum from the unit.

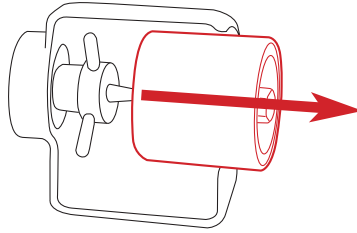

3. **IMPORTANT:** Turn the Chuck Throw Off anti-clockwise (towards you) so it is back at its original position.

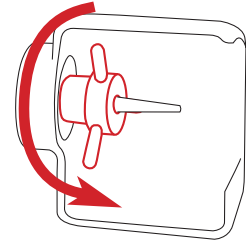

4. Push the Tapered Chuck firmly onto the Tapered Shaft. Give a good tap to the end of the Chuck to ensure a secure fit. The Tapered Shaft will hold the Chuck in place.

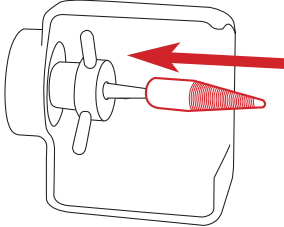

5. Take the Polishing Buff and screw it clockwise onto the Tapered Chuck (ensuring to screw on via the end with the plastic disc).

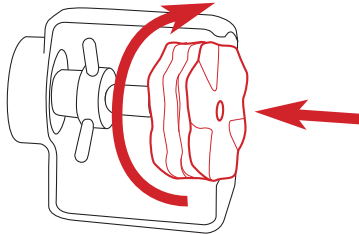

6. To Remove the Buff and Chuck, unscrew the Polishing Buff in an anti-clockwise direction and follow Steps 1-3 to remove the Tapered Chuck.

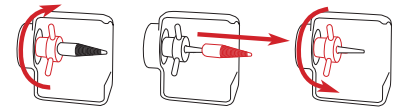

briggatemedicalcompany